

Mi Vacuum Cleaner G10/G9 Extended Battery Pack Charging Instructions



Charging Instructions

Method 1: Charging the battery pack on the extended dock

1. Remove the top cover of the 2-in-1 charging & storage mount.
2. Install the extended dock onto the 2-in-1 charging & storage mount, as illustrated.
3. Place the battery pack on the extended dock, then connect the 2-in-1 charging & storage mount to power to charge the battery.

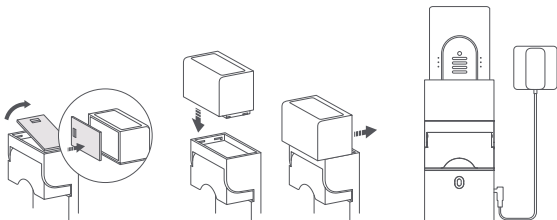

Method 2: Charging the battery pack on the vacuum cleaner

1. Press down the battery pack release button and slide the battery pack to the right, as illustrated, to remove it.
2. Install the new battery pack, then connect the vacuum cleaner to power to charge the battery.

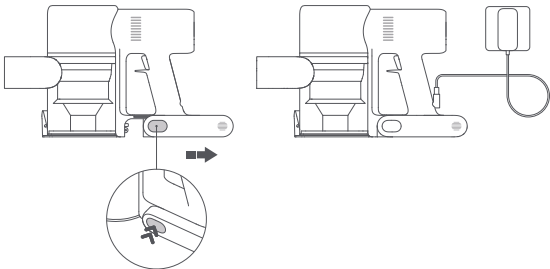

WEEE Information



All products bearing this symbol are waste electrical and electronic equipment (WEEE as in directive 2012/19/EU) which should not be mixed with unsorted household waste. Instead, you should protect human health and the environment by handing over your waste equipment to a designated collection point for the recycling of waste electrical and electronic equipment, appointed by the government or local authorities. Correct disposal and recycling will help prevent potential negative consequences to the environment and human health. Please contact the installer or local authorities for more information about the location as well as terms and conditions of such collection points.

Manufactured for: Xiaomi Communications Co., Ltd.

Manufactured by: Dreame (Tianjin) Information Technology Co., Ltd.

(a Mi Ecosystem company)

Address: Room 2112-1-1, South District, Finance and Trade Center, No.6975
Yazhou

Road, Dongjiang Bonded Port Area, Tianjin Pilot Free Trade Zone, Tianjin,
China

Importer:

Beryko s.r.o.

Pod Vinicemi 931/2, 301 00 Plzeň

www.beryko.cz